

Realwear HMT-1 Quickstart Guide



netnordic 
THE BEST COMPANION



Step 1: Fitting the Realwear HMT-1 and starting it up



Place the display close to your eyes underneath your eye in an upwards angle for three seconds to start the device

Step 2: Connect device to Wifi (optional use "Realwear Companion App" see p.2)

- | | |
|---|--|
| 1. Make sure you are in the home menu ("navigate home") | 8. Say "Select Item (number)" to select your network |
| 2. Say "My Programs" | |
| 3. Say "Settings" | 9. Fill in your password by hovering over the letters and saying "select". |
| 4. Say "Network & Internet" | |
| 5. Say "Wireless Networks" | 10. Say "Close keyboard" |
| 6. Say "Show help" to show numbers | |
| 7. Say "Hide Help" to close help menu | 11. Say "Connect" |

Step 3: Start Programm

1. Say "Navigate home" (to make sure you are in the home menu)
2. Say "My programs"
3. Say "programm name" (whichever programm you want to start) **OR**
Say "Select Item (number)" (item number of the programm)

How to install the Realwear Companion app The purpose of the companion app is to easily configure your Realwear HMT-1 by generating QR Codes on your smartphone. You can download the app on your Smartphone from the app- or play store by searching: ``Realwear Companion``



It doesn't react to my voice. What do I do?

1. Restart the headset
2. Do not touch any buttons.
3. If that doesn't work, contact support.

How to set volume?

1. From the home menu ("Navigate Home")
2. Say "My Controls"
3. Say "Volume"
4. Set level "Number"

Warning. The action button, located next to the power button, mutes the microphone of the Realwear.



How to select numbered options

1. Say "Show Help" to see numbers given to selectable options if not shown already.
2. Say 'Hide Help' to close the help menu
3. Select the option by saying: 'Select item number'

How do I turn on the flashlight?

1. Say "My Controls"
- 2.. Say "Flashlight On"

Device Overview

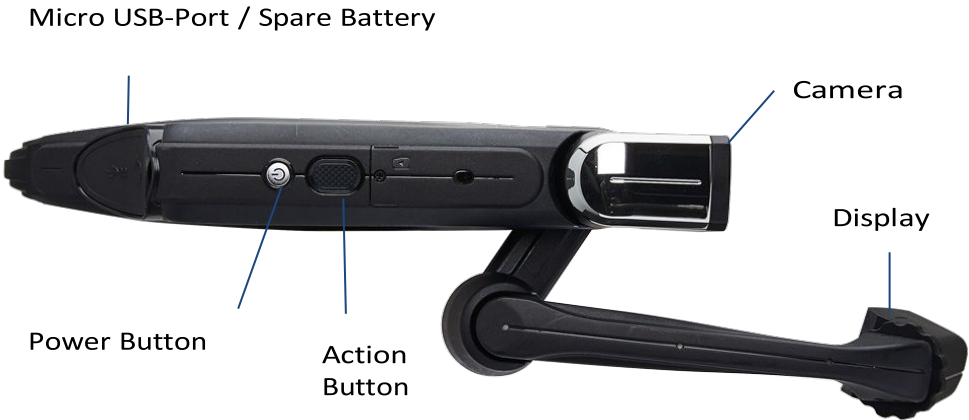

Voice command overview

Voice Command	Action
it for Navigate Home	Go to the Home Screen
Navigate Back	Go to Previous Screen
My Controls	Go to System Control Panel
Mute Microphone	Mutes the microphone
My Notifications	Opens the notification section
Recent Applications	Opens Applications running in background
Show Help	Shows help commands for current screen